

## Building Glass 12mm laminated Glass for Office Door

Building 12mm laminated Glass which made by two pieces of 6mm [float glass](#) bonding together with a layer or more and more adhesive film to make, its popular for office door, shop front door,etc. There's various design and pattern for choose as per required.

### What is laminated glass ?

[Laminated glass](#) is made up of two or more pieces of glass, connected by layer of organic polymer, through the special high temperature pressure(or vacuum)industrial heating process , made of glass and middle membrane permanent adhesive for the integration of composite glass products. chose any colour according to your needs.It 's widely used in our building,door,window,Office door Buildings, flooring, etc.

### Interlaces of product

Jimmy Glass Co.Ltd common laminated glass interlayer : PVB /SGP/EVA/PU,  
PVB inter-layer is the best structural adhesive that to absorbed of sound.

### The technology of product

All of the Laminated glass divide into clear float glass and deep processing; included Tinted, Reflective, Low Iron, Etched, Mirrored, pattern, Color smart, Thermonuclear and Low E combinations. All of glass the main colour included  
Grey,blue,green,it is depth to darker and light color.

### Laminated glass Availability

Glass name□Building laminated safety glass
Max size□3300mm*13000mm
Size□1830mm*2440mm□2140mm*3300mm□2140mm*3600mm□2250mm*3300mm□2250mm*3660mm□ etc
Thinckness:2mm-19mm□as customer requirement
PVB:0.38mm and multiope of 0.38mm(PVB/SGP/EVA)
PVB colior:red,white,yellow,any pantone color
Feature1:Transparent,anti-explosive,waterproof and ultraviolet_proof
Feature2:high srength good resilience
Category:safety glass,laminated glass,vacuum glass.curved laminated glass ,etc
Function:wind and impact resistance safety

### Laminated glass Features

- Extremely High Safety: The PVB film has strong tenacity and from impact. Even if it's broken, the splinters will adhere to the interlayer and not scatter.
- Heat Insulation & Energy Saving:The dry air in between the glass layers has 1/27 coefficient of heat transmission,it lowers the heat transmit through the glass.
- Sound Proof: Reduce 1000HZ—2000HZ double noise through.
- Good Shading Effect With Hing Visible Light Transmittance:Clinometer coating technology is can ensure higher visible light transmittance and enough natural light through into indoor space.also can effectively prevent 99% ultraviolet light.

### **Laminated glass Application**

- Sloped/Overhead Glazing
- Museums, Prisons, Government Buildings
- Jewelry Stores, Banks, Airports
- Safety Glazing Applications
- Schools, Hospitals, Hotels, doors, windows
- Interior Partitions, Office Buildings, flooring
- Many Others.

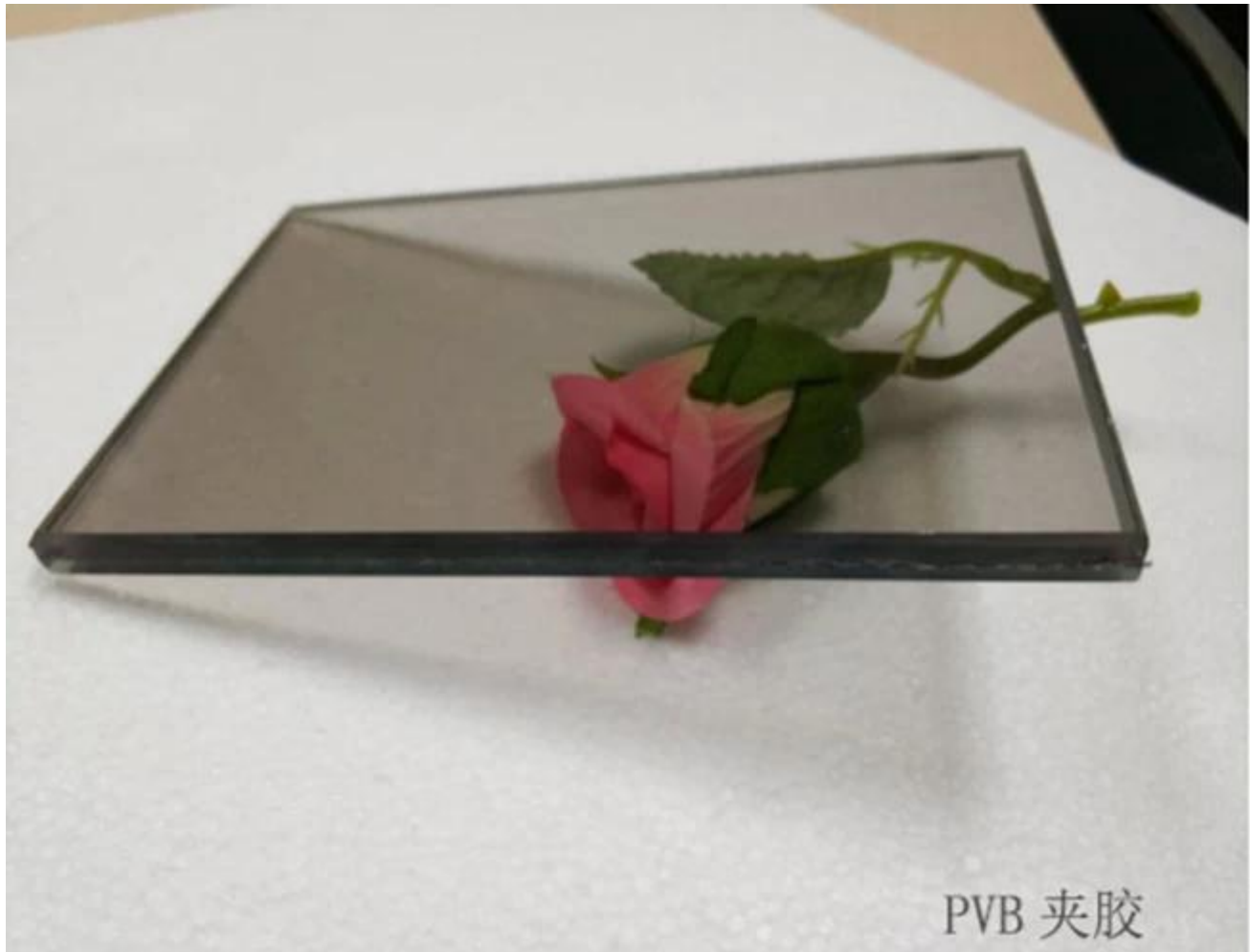

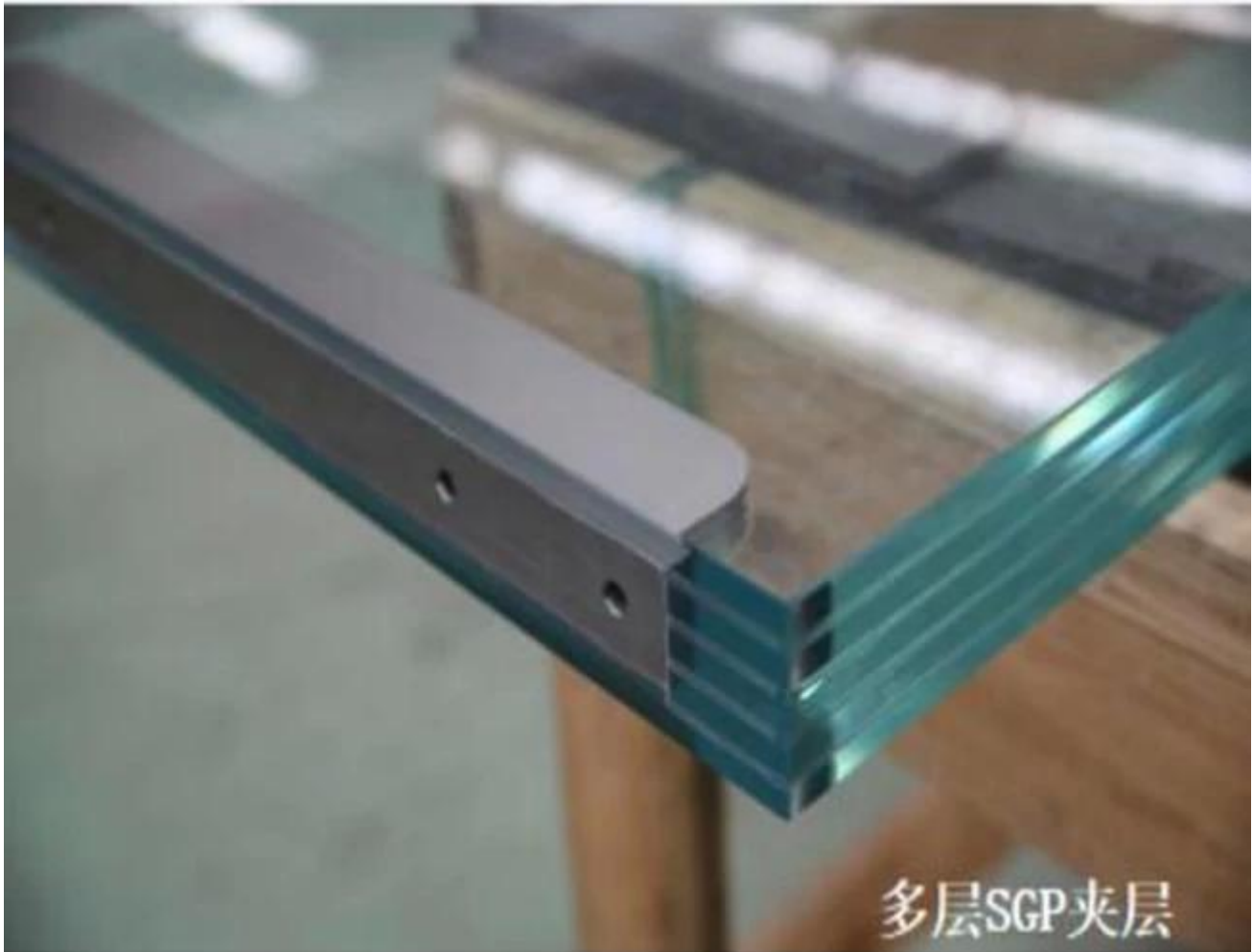

多层SGP夹层

**Building laminated glass [PVB&EVA]**



colored laminated glass



tawny laminated glass



clear laminated glass



Fabric laminated glass



Fabric laminated glass



Wired laminated glass

**laminated glass for office door application**

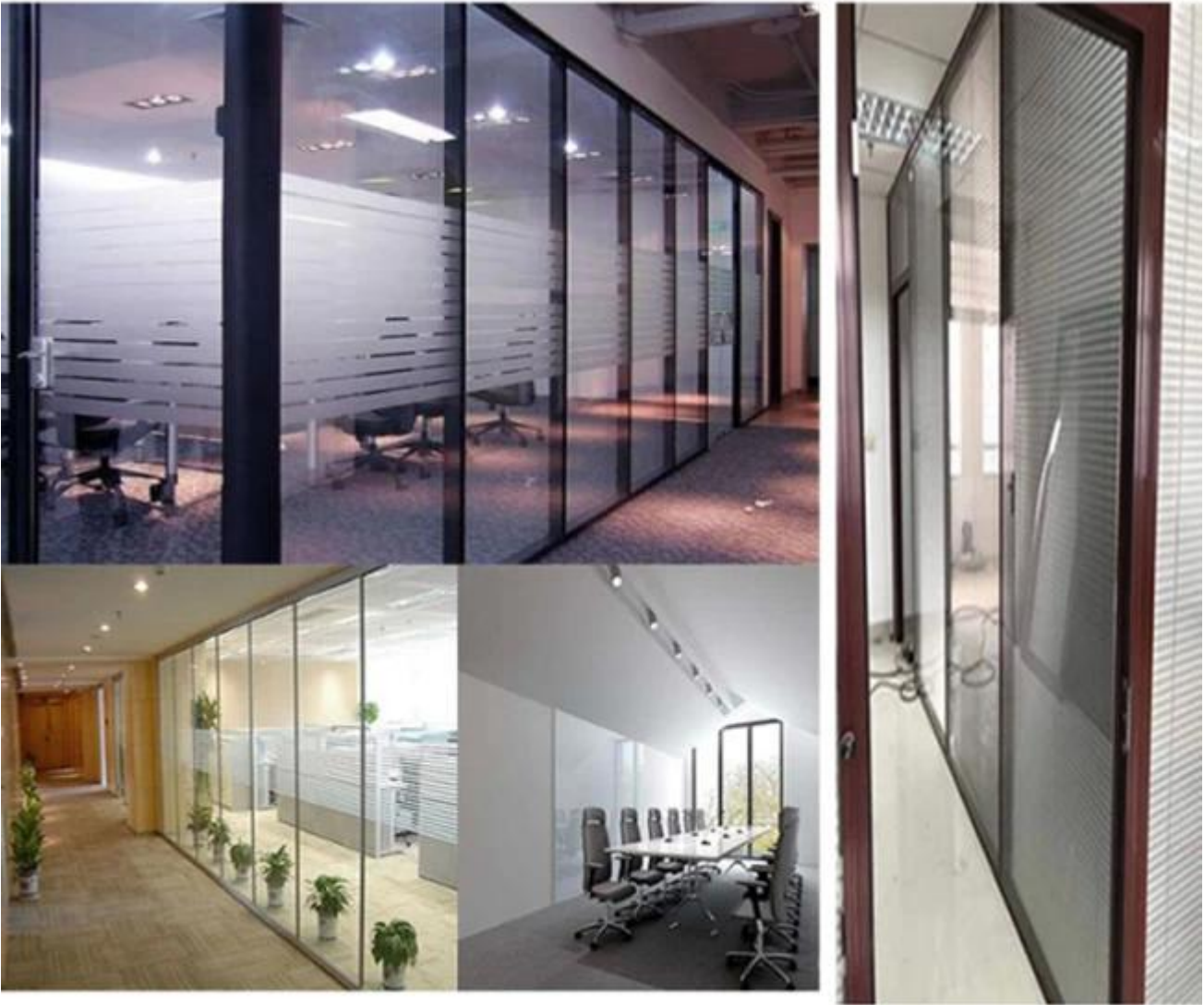

picture of product line



**packing**

